

I-33

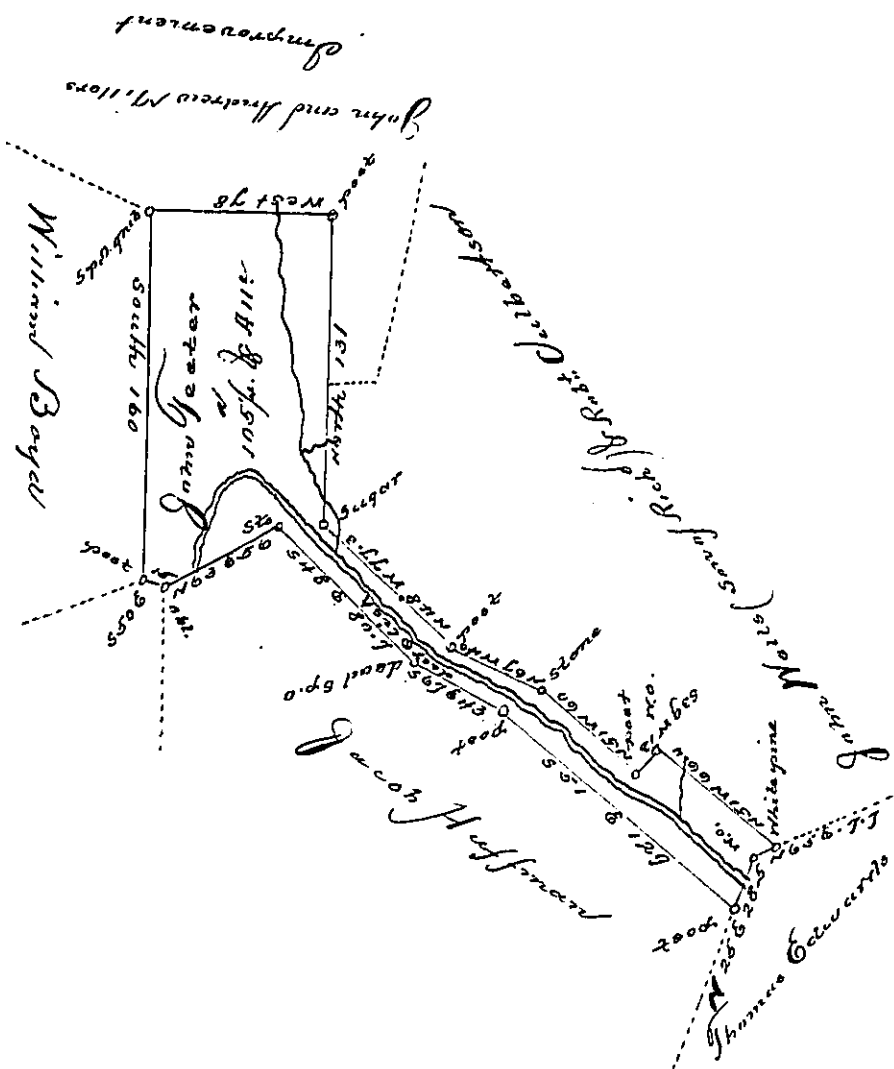

Situate on Puncher Camp Riv a branch of Brush Creek including a large Deer Lick,  
 Now in Southampton Township, Somerset County (formerly Londerry Township  
 Bedford County) and Surveyed the 9th day of November 1793, by George Woods  
 Esq<sup>r</sup> Late D.S. as appears by his official Draught remaining in my Office. In  
 pursuance of a Warrant granted unto John Tector dated the 23<sup>d</sup> day of October  
 1792 — Certified the 28<sup>th</sup> December 1804

Pr. John M<sup>c</sup>Cleand, Deputy

To Samuel Cochran Esquire  
 Surveyor General

Note. I have not got the warrant of Tector  
 in my possession to examine the location of it, therefore I hope to be Excused  
 if it is not descriptive of the Land.

John M<sup>c</sup>Cleand

Sam<sup>l</sup> Cochran, Esq<sup>r</sup> S<sup>r</sup>g.

IN TESTIMONY that the above is a copy of the original remaining on file in the  
 Department of Internal Affairs of Pennsylvania, made con-  
 formably to an Act of Assembly approved the 16th day of  
 February, 1833, I have hereunto set my Hand and caused  
 the Seal of said Department to be affixed at Harrisburg, this

\_\_\_\_\_ day of \_\_\_\_\_, 1896

James W. Fatta  
 Secretary of Internal Affairs.